



SEPT. 15-22

PRICES SUBJECT TO CHANGE



Friday to Friday Sale



TWIN CAM A 99'-06'

Equipped with the Timken® sprocket shaft bearing (OEM 9028) and late model pinion bearing (OEM 24605-07).

SMALL CAM JOURNAL, 7/8" (OEM 9198 SIZE BEARING)

206104 Ultima® standard bore, 4.065 spigot, Silver finish (stock replacement)



SHOVELHEAD 70'-84'

Large bore breather for increased crank case vacuum and less blow by.

5 PC FLYWHEEL DESIGN

206125 Stock bore case, Natural finish. 74 C.I. and 80 C.I. Uses 1984-1991 EVO oil pump.



EVOLUTION STYLE 84'-99'

Machined for both bottom, case, and top, cylinder head, breathing systems.

5 PC FLYWHEEL DESIGN

206153 1984 Thru 1991, 3.625" bore Black finish.
206142 1992 & Later 3.875" & 4.000" bores, S&S® bolt pattern, Natural.
206143 1992 & Later 3.875" & 4.000" bores, S&S® bolt pattern, Black.



COMBINATION SPEEDO/TACH

2:1 Ratio unit works with OEM transmission speedo drive units on 1947 thru 1967 FL and late model front wheel speedo drive applications. 16MM nut.

571100 2:1 Ratio speedo/tach. **SOLD EACH**

LATE STYLE SPEEDOMETER WITH 2240:60 RATIO

Fits Softail® models 1991 thru 1995 with front wheel speedo drive unit and self-cancelling turn signals.

571168 Speedo with OEM style face. OEM 67027-91A. **SOLD EACH**



57-265



57-96
CHROME PLATED

SPEEDOMETER FOR FAT BOB® STYLE DASH

NOTE: The exact face colors & numbers may vary with availability from manufacturer. Ratio will be correct. 5/8 x 18 nut.

2:1 RATIO SPEEDOMETERS

These speedometers are for FL 1947 thru 1967. They can also be installed on late FX with stock front wheel speedo drive unit (OEM 67127-73).

57182 Speedo with 1950 style numbers. **SOLD EACH**

SPEEDOMETER RESET KNOBS FOR H-D®

57196 Knob & screw set. Fits all models Big Twin with large tank mounted speedo, 1968 thru 1989 and all import speedometers. OEM 67215-68 and 67217-68. **SOLD AS SET**

571265 Dust boot. Replaces OEM 67880-94. **SOLD EACH**



GAUGE HOUSING BRACKET KIT FOR SUPER GLIDE®

Dash bracket kit includes all necessary parts for proper installation. **SOLD AS KIT**

57178 Kit is used when installing Fat Bob® tanks on H-D® 74" & 80" and with Super Glide® style gauges used with OEM.

CUSTOM MINI GAUGES



57-131

57-133

Custom speedometer and tachometer gauges with a polished stainless bezel and chrome housing. Comes complete with chrome mount, and 12V dial light. **SOLD EACH**

57130 1:1 Ratio speedometer. Fits FX 1971 & 1972, FL 1968 thru 1980, and FXWG 1980 thru 1983 with transmission drives.

57131 2:1 Ratio speedometer. Fits Sportster®, FX & FXR, 1973 thru 1990 with front wheel drive, Sportster® 1954 thru 1972, and FL 1947 thru 1967 when using transmission speedometer drive. **NOTE:** Can be used on 1991 & later models if self-cancelling turn signals are not used.

57133 Electronic tachometer.



48MM SPEEDOMETERS

Features:

- Easy push button recalibration
- LED illuminated face
- Polished stainless housing and bezel
- LCD odometer with resettable trip meter.
- Mechanical and electronic styles available.
- 60mm speedometers come with handlebar clamp.
- All sizes and ratios have 140 mph faces.

48MM ELECTRONIC SPEEDOMETER (FITS 95'-06' HD)

571336 White face

SOLD EACH

571337 Black face

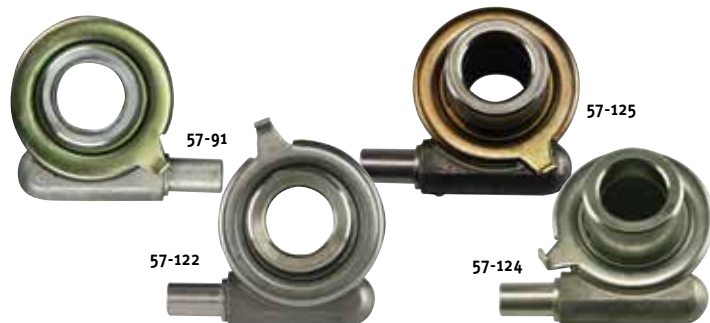

SPEEDOMETER DRIVE UNITS

SOLD EACH

57191 6T, Fits 1980 FX models (except FXWG), equipped with 85 mph speedometer. OEM 67124-80.

57127 Fits FLT & FLHT, 1982 thru 1986 and FL 1981 thru 1984 4 speed. OEM 67073-81.

57126 Fits FXR, FXD & Sportster® with 19" wheel, 1984 thru 1995. OEM 67127-84A.

57122 Fits FLT & FLHT, 1987 thru 1995. OEM 67073-87A.

57123 Fits FXLR 1987 thru 1994. OEM 67132-85A.

57124 Fits FLSTF & FLSTC, 1986 thru 1995. OEM 67125-86A.

REAR MASTER CYLINDER

90153 Fits 08'-10' FLT, chrome. OEM 41763-08. SOLD EACH



HANDLEBAR MASTER CYLINDER COVER

For handlebar master cylinder on all H-D® models 1972 thru 1981. Replaces OEM 45057-72.

90165 Plain chrome plated cover.. SOLD EACH

BRAKE PLUNGER & CLEVIS



90166 PLUNGER & CLEVIS 1970 / 1979 (OEM 42333-70)

HANDLEBAR MASTER CYLINDER KITS



For handlebar master cylinders on Big Twin & Sportster®, all models 1996 & later.

901524 Rebuild kit for single disc brake. SOLD AS KIT
OEM 45006-96. 9/16" Dia. piston.

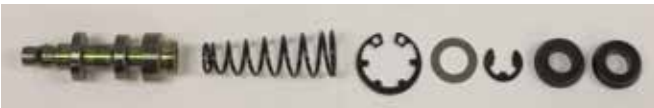

For handlebar master cylinders on FLT 2008-up. **NEW!**
471267 Rebuild kit. OEM 42862-06A. SOLD AS KIT

REAR MASTER CYLINDER KITS



For rear master cylinders on FXR 1982 thru early 1987.

901429 Rebuild kit. OEM 42382-82B. SOLD AS KIT



HANDLEBAR MASTER CYLINDER FITTING

901329 90° Right angle inverted flare, male end 1/8 pipe thread. Fits 1971 thru 1981. OEM 43307-78. SOLD EACH



STAINLESS STEEL OIL PRESSURE GAUGES

These new oil pressure gauges are precision made to ISO standards. Each gauge is glycerin filled and tested for accurate readings. Outer case is made from stainless steel and internal parts are quality brass.

57120 Black oil pressure gauge 60 PSI / 4Bar
57121 White oil pressure gauge 60 PSI / 4Bar

DUST BOOTS

For Big Twin Rear Master Cylinders



901208 Dust boot for 1958 thru 1969. OEM 41764-58.
901202 Dust boot for 1970 thru 1979. OEM 41764-70.

SIGHT GLASS FOR MASTER CYLINDER COVER



Sight glass for stock type master cylinder top cover for all models Big Twin and Sportster®, 1996 & later.

901211 Sight glass only. OEM 45042-96.



ALL KITS
CHROME PLATED

ULTIMA® HANDLEBAR CONTROL KITS 1996 THRU 2004

Fits Big Twin and Sportster®, 1996 & later (except FLT and FXRT with radio controls). SOLD AS KIT

471256 For single disc models. 9/16" Bore master cylinder.

HANDLEBAR MASTER CYLINDER ASSEMBLY



Complete Master Cylinder Assy. With Hand Lever, Handlebar Clamp Not Included. For Big Twin & Sportster 1996.

901522 .687 — 11/16" Bore For Dual Disc (OEM 45013-96)

901523 .5625 — 9/16" Bore For Single Disc (OEM 45019-96)



ULTIMA® BILLET FORWARD CONTROLS FOR 2000 - UP BIG TWIN

These high quality forward controls are machined from billet aluminum then polished or anodized to a show quality finish.

Master cylinder bore diameter is 3/4". SOLD AS KIT

471331 Forward control set, black anodized

LATE MODEL FORWARD CONTROLS 2007-2017 FL

471245 Chrome 07-17 FL forward control kit OEM 33909-08A

471246 Black 07-17 FL forward control kit OEM 33909-08A.

Fits: 2007-17 FLSTC / FLSTF / FLSTN / FLSTSB / FLSTSC models.

ULTIMA® BILLET FORWARD CONTROLS FOR '36 -'99 BIG TWIN

These high quality forward controls are machined from billet aluminum then polished or anodized to a show quality finish.

471441 Forward control set, black, 3/4" Bore

471540 Forward control set, polished, 5/8" Bore

471541 Forward control set, black, 5/8" Bore

471546 Master cylinder rebuild kit, 3/4" Bore

471547 Master cylinder rebuild kit, 5/8" Bore

