



Friday to Friday Sale

JAN 8-15



CHAIN BREAKER & RIVETING TOOL KIT

97x21 This Kit is supplied with adequate components to break chains from #35 to #630. It can be used on cam chains and drive chains.

Contents:

- Handle
- Lever
- Spring
- Two press plates
- Large anvil and small anvil
- H.S.S. Rivet tip for riveting hollow nose master links
- Body, alignment bolt and push bolt
- H.S.S. 2.2mm breaking tip for most cam chains
- H.S.S. 2.9mm breaking tip for chains #25 - #35 only
- H.S.S. 3.8mm breaking tip for chains #428 - #630
- Upper and lower guide for 2.2mm breaking tip

NEW!



CHAIN BREAKER

97x23 This Chain Breaker is equipped with two hardened pins in 4.0mm. It covers the gamut from 420 to 620 chains. The handle can be folded away for easy storage.

NEW!



MASTER LINK PLIERS

Many chains use a "master link" that allows the chain to be replaced by hand, over time, wear, dirt and corrosion can make it difficult to separate by hand.

Master Link Pliers can solve the problem and make removal and replacement of these master links quick and effortless. Insert the jaws into the master link and squeeze the handles until link is separated.

97x24 Master Link Pliers

NEW!

NEW!

6 SPEED BEARING INSTALLER TOOL



Use for 6-Speed main drive case bearing installer, holds bearing square to its bore, eliminates marring of the bearing bore. It fits H.D FXD '06-up & Big Twin'07-up 6 Speed models.

97x430 6 Speed bearing installer tool SOLD AS KIT

CRANK SHAFT TURNING/ROTATING TOOL

NEW!



97x431 Crank shaft turning/rotating tool.

CLUTCH ALIGNMENT TOOL

NEW!

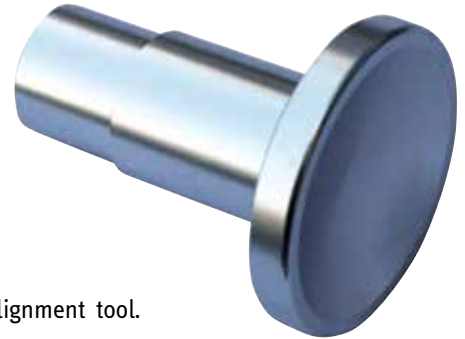

97x432 Clutch alignment tool.

A. WRIST PIN REMOVAL & INSTALLATION TOOL

97x406 Wrist pin removal and installation tool.



B. TAPPET BLOCK / OIL PUMP ALIGNMENT SCREWS

97x403 Set of three alignment screws.



C. IGNITION SWITCH HOUSING ALIGNMENT TOOL

97x405 Ignition switch housing alignment tool.

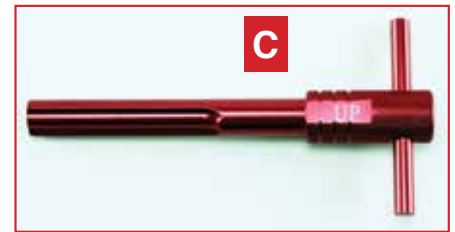

D. PRIMARY DRIVE HOLDING TOOL

97x404 Primary drive holding tool.



E. TAPPET SCREEN PLUG TOOL

97x411 Tappet screen plug tool.



WRIST PIN CLIP REMOVAL & INSTALLATION TOOL

97x417 Wrist pin clip removal & installation tool.



PISTON PIN KEEPER TOOL

97x416 Piston pin keeper tool.

A

A. WHEEL BEARING REMOVAL & INSTALLATION KIT

Wheel bearing removal and install tool is a must for every shop. Removes and installs 3/4 25mm & 1" sealed bearing for 2000-later wheels.

97x290 Wheel bearing removal & install kit.

B

B. STEERING HEAD BEARING RACE INSTALLATION TOOL

97x409 Steering head bearing race installation tool.

C

C. SWINGARM PIVOT BEARING PULLER

97x407 Swing arm pivot bearing puller tool.

D. MAIN-SHAFT BEARING RACE PULLER / INSTALLER SET

97x401 Main shaft bearing race puller & installer set.

E. 5 SPEED MAIN DRIVE GEAR TOOL

97x414 5 Speed main drive gear tool.

D**E****F**

F. MAIN DRIVE GEAR SEAL INSTALLER TOOL

97x421 Main drive gear installer tool.

G

G. INNER CAM BEARING CAM BEARING REMOVAL & INSTALLATION TOOL KIT

97x415 Inner cam bearing removal & installation tool kit

H

H. CAM COVER PULLER

97x419 Cam cover puller.



A

A. CLUTCH HUB PULLER

Use to remove clutch hub without removing clutch release rod. Puller works on wet and dry clutches. 4 bolts included for dry clutch removal. Pat. Pending

97x422 For all H-D® Big Twin 1936-90.



B

B. OUTER CAM BEARING PULLER

It is designed to remove the bearing straight from the camshaft without slipping or binding. Pat. Pending

97x423 For H-D® 1999 – 2006 models.



C

C. INNER CAM BEARING PULLER

Easily removes inner cam bearing without damaging the crankcase. It also can keep rollers from falling into the crankcase during removal. Pat. Pending

97x424 For H-D 57-90 Sportster, 57-85 XL and 87-90 Buell



D

D. ALTERNATOR ROTOR REMOVER

It will protect threads on sprocket shaft from damage while pulling rotor free from its magnetic hold.

97x425 For Harley-Davidson® 1997 to present FLHT Ultra or any Big Twin with a 45 AMP high output charging system.

E. TRANSMISSION DOOR REMOVER TOOL

Use to remove the complete door with gears and shafts from the transmission. Just prepare the trans for disassembly, bolt this tool to the outside of door, and place the two supplied press pins into the two screw holes of trans case. Thread in two of the screws, securing the door to case, and the door is pulled from case. Can be used with transmission in frame.

97x426 Fits all 2006 Dyna and 2007 FLHT & FXST.



E

ULTIMA® DYNA 3.35" PRIMARY BELT DRIVE



Ultima Dyna® Beltdrive Kits fit both Evo and TwinCam 1990-2006 Dynas with no modifications needed.

The aluminum backing plate is billet 6061-T6.



58x902 3.35" Belt Drive Assembly, Street Style

ULTIMA® EVO & TWIN CAM® SOFTAIL® 3.35" PRIMARY BELT DRIVE



Features an extra plate clutch assembly and Goodyear 85mm wide (3.35") belt

58x947 Street Style Belt Drive Assembly--Black, cast backing plate, 1990-2006.

ULTIMA® ENGINE CASE EVOLUTION STYLE 84'-99'



These cases are produced from prime C356-T6. Machining is done on state of the art CNC machining centers using hydraulic fixturing for repeatability. This along with other solid quality features like counter bored allen case bolts, large 1/4" NPT drain plug, and a high volume ported breather make these a professional engine builders choice for your next high performance engine. All case kits come with the main bearings, cam bearing, chromoly cylinder studs installed and the pinion race sized to 1.751". Also included are the main seal, main seal spacer, top end feed screen and spring, chrome timing hole plug, stainless steel case bolts and the oil pressure gauge.

Note: Sized for red pinion

ENGINE CASE KITS

- 206x52** 1984 Thru 1991, 3.625" bore Natural finish case kit.
- 206x53** 1984 Thru 1991, 3.625" bore Black finish.
- 206x56** 1992 & Later, 3.500" bore Natural finish.
- 206x50** 1992 & Later, 3.625" bore Natural finish.
- 206x46** Fatso™ Gen 2 engine case, Natural finish.
- 206x47** Fatso™ Gen 2 case, Black finish.
- 206x43** 1992 & Later 3.875" & 4.000" bores, S&S® bolt pattern, Black.
- 206x48** 1992 & Later 4.250" bore, Ultima® 120 & 127 C.I., Natural finish.

ULTIMA® 6-SPEED RIGHT SIDE DRIVE TRANSMISSIONS



FEATURES INCLUDE:

- GEARS AND SHAFT MADE FROM 8620 STEEL FOR DURABILITY
- PRO-CUT LEAD IN RAMPS FOR POSITIVE SHIFTING
- HARDENED STEEL SHIFT FORKS FOR DURABILITY
- ROLLER DETENT FOR ULTRA SMOOTH SHIFTING
- BILLET TRAP DOOR
- PERMANENT MOLD TRANSMISSION CASE MACHINED FROM A356-T6
- CLOSE RATIO 2.94 LOW GEAR SET
- .86 OVERDRIVE 6TH GEAR
- DESIGNED TO USE OEM STYLE SPEEDOMETER SENSORS
- ASSEMBLED BY PROFESSIONALS.
- 32 TOOTH PULLEY INCLUDED.

This transmission will handle any of the high horsepower engines we've created and are delivered with a 12 month, 12,000 mile warranty.

- 201x31** Cast Finish Cable
- 201x32** Black Finish Cable
- 201x33** Polished Finish Cable

